

*Moving  
freely.  
Elevating  
lives*

CORPORATE PROFILE





## — Company Message

### *Brand Statement*

Every day across the world, millions of people have their lives diminished by obstacles like stairs, steps and uneven surfaces. For them, the joys of city life are out of reach. That's why FUJITEC makes elevators and escalators, that enable people to move freely and overcome obstacles regardless of age, physical ability or economic status. The safety and reliability of our products allow people to go anywhere at any time, enjoy new experiences and connect to new opportunities. We get close to people to understand their needs and desires and then realize them. That's how we develop beautiful and functional cities where everyone can fulfill their dreams. This lies at the heart of our DNA. We collaborate with people from nations around the world because we believe that our elevators and escalators are there to improve the lives of everyone, everywhere.

### *Brand Vision*

## Moving freely. Elevating lives

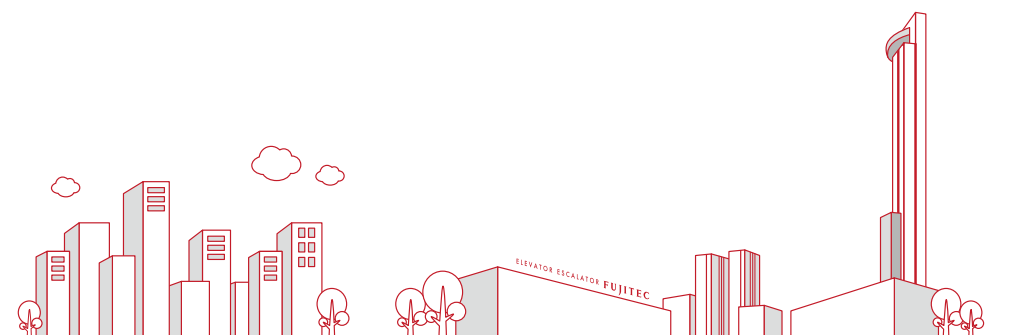



**— Values**

We shape beautiful and functional cities by delivering innovative products and solutions. Every day, our products transfer people to their destinations smoothly and seamlessly. As a globally recognized company with a strong reputation among people worldwide, Fujitec continues to contribute to the development of nations across the globe. We deliver innovative, high-quality products to create the cities of a new age.

**One Step Forward**

Fujitec aims toward our dream: that all people living in the world may move freely in any direction within their cities by using our elevators, escalators, and moving walks.

**One Step Above**

Fujitec continues to step up toward an ideal level of technology that brings happiness to people and prosperity to cities around the globe.

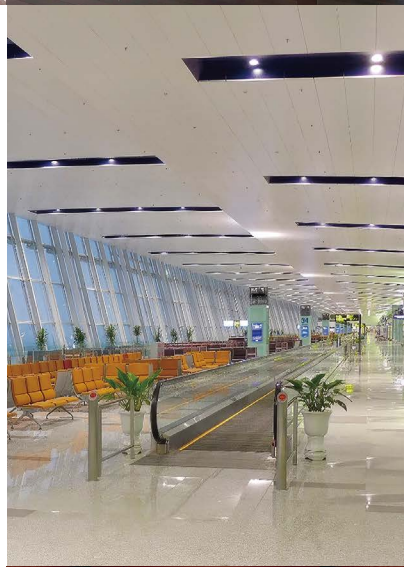

## Existing Portfolio

Fujitec offers a wide range of services for your elevator maintenance and modernization needs. By understanding your unique business objectives, we create and execute a tailored plan designed to meet your specific goals.



## New Installations

Fujitec delivers specialized, custom-engineered solutions rooted in safety, quality, and passenger comfort. By analyzing your requirements, we optimize every installation for the highest levels of energy efficiency and reliability.

## Modernizations

As a leader in vertical transportation modernization, we specialize in Fujitec and multi-brand OEM systems. We assign a dedicated specialist to every project to ensure our solutions consistently exceed Fujitec's rigorous safety standards, quality benchmarks, and all jurisdictional code requirements.



## INSPIRING WAYS WE TRAVEL

We shape beautiful and functional cities by delivering innovative products and solutions.

Everyday our products transfer people to their destination smoothly and seamlessly.



## A Specialized Manufacturer with Global Experience

Founded in Japan in 1948, the Fujitec Group has built a reputation over the years for providing high-quality products to many iconic buildings around the globe. Our history as a specialist manufacturer has given us the technological excellence and product quality that make our elevators, escalators, and moving walks in demand worldwide.

Since our founding, the company has striven to care for every stage of our product's life cycle: ensuring product endurance through quality engineering, offering flexible programs for new installations, modernizing product lines, and providing preventative maintenance services.

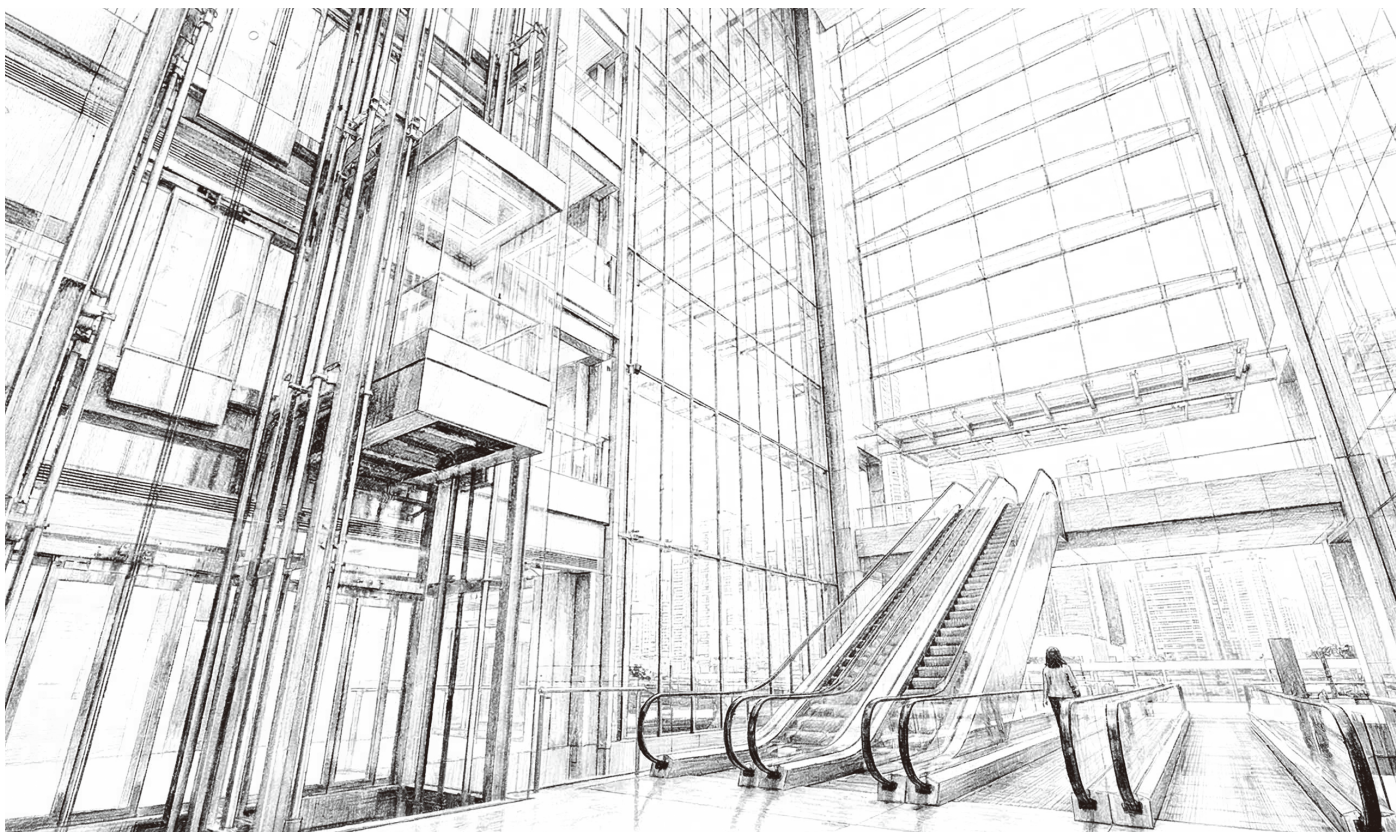

### ELEVATOR

Deliver safe and comfortable vertical transportation. Support smooth mobility across a wide range of buildings.

### ESCALATOR

Provide safe and reliable people flow. Enhance everyday movement with comfort and ease.

### AUTOWALK

Enable comfortable horizontal transportation. Ensure smooth and safe movement in public spaces.



## — Company Outline

Company Name Fujitec Co., Ltd.

Established February 9, 1948

### Head Offices & Major Facilities

Big Wing (Global Headquarters)  
591-1 Miyata-cho, Hikone-shi, Shiga 522-8588, Japan

Tokyo Head Office  
1-17-3 Shirokane, Minato-ku, Tokyo 108-8307, Japan

Big Fit  
1-28-10 Sho, Ibaraki-shi, Osaka 567-8510, Japan

Big Step  
180 Soden, Hidaka-cho, Toyooka-shi, Hyogo 669-5398, Japan

Tokyo Fit  
10-11 Haneda Asahi-cho, Ota-ku, Tokyo 144-0042, Japan

### Business Activities

Research & Development, Manufacturing, Sales, Installation, and Maintenance of Elevators, Escalators, and Moving Walks

Capital 12,533 million yen (as of the end of March 2025)

### Corporate Philosophy

Fujitec values people, technologies, and products.  
Together with people around the world, we create beautiful urban functions suited to a new era in countries across the globe.

[View Company Profile](#) →



## — History

- 1948** Fujitec Co., Ltd. is founded for the purpose of R&D, manufacturing, sales, installation, and maintenance of elevators.
- 1964** Fujitec (HK), the first overseas office, is established.
- 1974** The company is listed on the First Section of the Tokyo Stock Exchange.
- 1989** The Hidaka Plant of Fujitec Japan begins operation.
- 1993** Fujitec Co., Ltd. becomes the first in the Japanese elevator industry to obtain ISO 9001 Certification.
- 1999** Fujitec Co., Ltd. obtains ISO 14001 Certification.
- 2004** Fujitec India Private Ltd. is established.
- 2005** Head office, R&D, and production facilities are integrated at "Big Wing." The 170m Research Tower was the world's tallest at the time.
- 2010** The escalator development and manufacturing base "Big Step" is completed.
- 2010** The aftermarket base "Big Fit" is completed.
- 2011** The elevator plant in Chennai, India, starts operation.
- 2014** ZEXIA / REXIA, the new global-standard elevator models from Fujitec, are developed.
- 2017** "WING SQUARE" is completed at Big Wing.
- 2022** "Big Rise" tower is completed at Fujitec India Private Ltd.
- 2025** "Wisdom Square" Elevator and Escalator Quality Evaluation Facility is completed.



Osaka manufacturing plant with a 15-unit elevator research tower (1962)

## 1948 →

### Seeking to help rebuild the nation

#### Swift overseas expansion after founding

The Company was founded by Shotaro Uchiyama, who was deeply moved upon witnessing Osaka's war-torn streets gradually regain their former appearance. Driven by a desire to help rebuild the nation and its cities, he established the business. Foreseeing the evolution of a globalized society, he quickly turned his attention to international markets. Under the philosophy that "the world is a single market," he accelerated the Company's business expansion.

## 1974 →

### World's largest elevator research tower completed

#### Pursuing the challenge of original technologies

Anticipating the era of skyscrapers, we continued pursuing innovative technologies, including developing the world's tallest elevator research tower and a high-speed elevator with a speed of 600 meters per minute. In the late 1970s, as microcomputers entered the practical application phase, we began developing microcomputer control technology for standard elevators ahead of other companies.



150-meter elevator research tower, tallest and largest in the world\*(1975)



The "Hidaka Plant," went into full-scale operation (in February 1990).

## 1990 →

### Expansion into the world's most promising market: China

#### Targeting further business growth

In the 1990s, as urban development accelerated in China and elevator demand was expected to grow rapidly, we shifted from the traditional concept of enhancing technical capabilities solely through collaboration with other elevator-related companies. Instead, we focused on providing our technological expertise across China through an extensive network. To achieve this, we established a joint venture, Huasheng Fujitec, with Chinatex Corporation, a leading general trading company.

## 2008 →

### Supplied landmark buildings around the world

#### Accelerating global brand rollout

Our exceptional technology and products, backed by a rich history, robust global network, and strong relationships we have built with customers over the years, have earned us deep trust. This trust has enabled us to supply elevators and escalators to landmark buildings around the world. In ever-evolving cities worldwide, we continue to embrace new challenges with a vision for the future.



Big Wing



Products & Service

## Innovative Models: Elevators, Escalators, and Moving Walkways

Fujitec always thoroughly discusses requirements before beginning design outlines. To match the customer's original design concepts with building requirements, ceiling lighting and car interior colors can be customized.

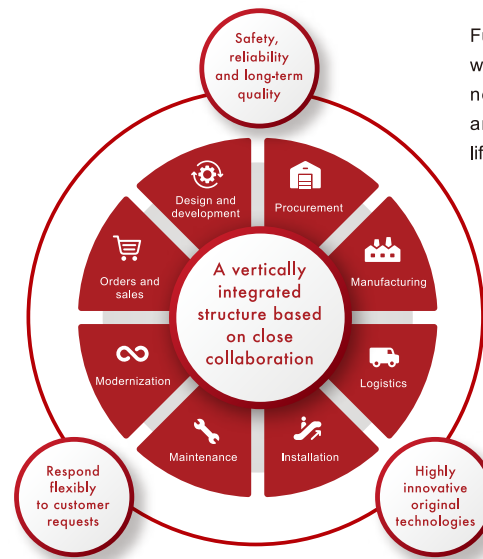

Fujitec provides customers with innovative products, new functional systems, and solutions for the full life cycle of the equipment.



## Global Standard Elevators

**ZEXIA**

Global standard elevator with machine room.

**REXIA**

Global standard elevator without machine room.

**ELSIA**

High-speed global standard elevator with machine room.

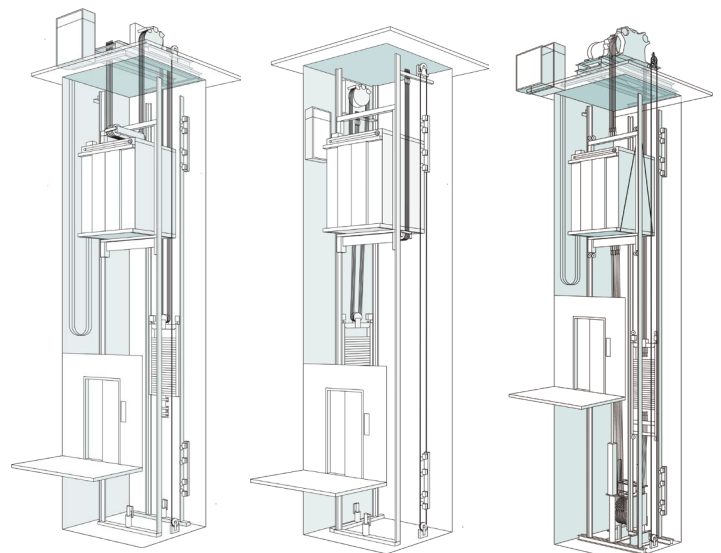

## Functional Systems

### **EZSHUTTLE**

Destination Floor Guidance System

A functional system compatible with both new and modernized elevators. It allows passengers to register their destination before entering the elevator. By assigning the most suitable elevator, passengers' traveling time and lobby congestion are significantly reduced.



## Double-Deck Elevators

Double-deck elevators serve two floors simultaneously. This type of elevator is applied to large-scale buildings with complex facilities. Fujitec's double-deck solutions manage massive flows of people efficiently.



## Global Standard Escalators & Moving Walkways

### **GS8100**

Global standard Moving Walkways.



### **GS8000-NX**

Global standard escalator.



## Solutions for the Full Life Cycle

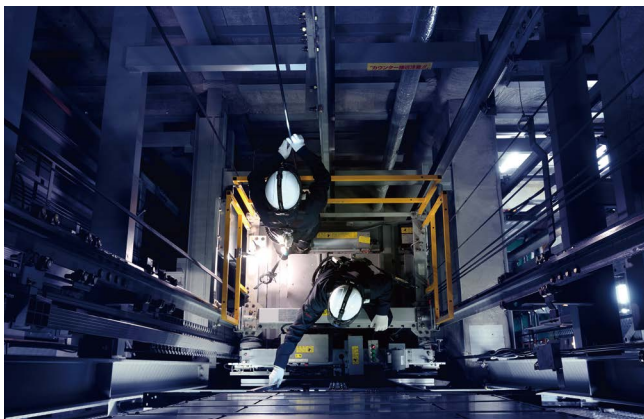

### **Product Quality Maintenance**

Fujitec prepares various maintenance programs to keep products operating in optimal condition.

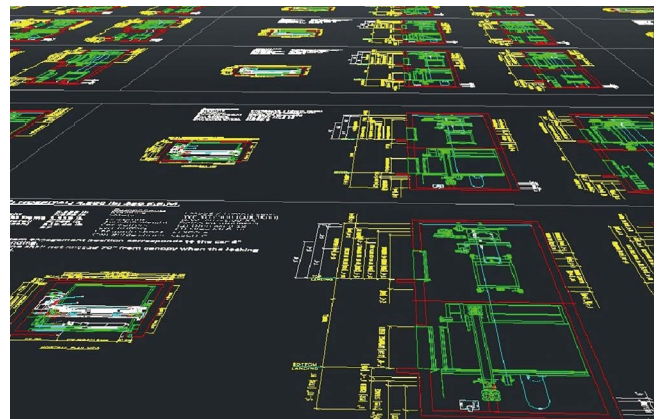

### **Product Modernization**

As products serve customers for decades, they eventually become outdated. During this period, building usage, aesthetic trends, and safety standards change. Drawing on our experience as a specialized manufacturer, Fujitec offers modernization solutions to meet these changes.



## Global Production & R&D Network

Fujitec's globally established business system—integrating Production Bases, R&D Centers, Parts Supply Centers, and Remote Monitoring Centers—delivers "Japan Quality" to customers around the world.

## Development of Next-Generation Elevators

In the 170m research tower at Big Wing, Fujitec develops next-generation technology, including elevators capable of traveling at speeds of over 1,000 meters per minute for ultra-high-rise buildings.

## Worldwide R&D for Cutting-Edge Technologies

Fujitec organizes its global R&D facilities to collaborate and create cutting-edge technologies. This cross-border collaboration produces the next generation of elevators and escalators.

- Branch
- Sales Offices / Service Centers, etc.

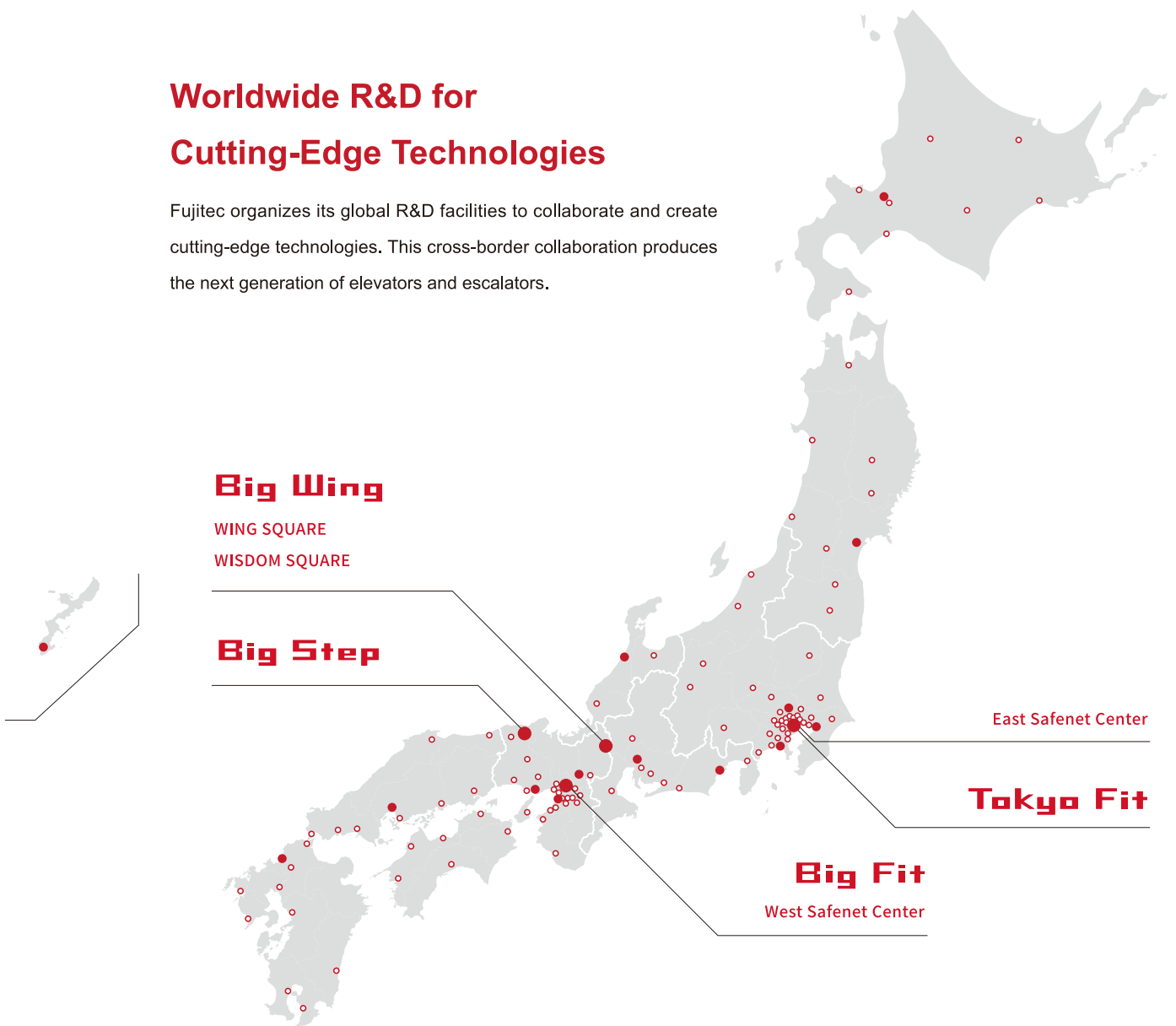



### Big Wing (Japan)

The Global Head Office and main R&D Center. It manufactures elevators for the Japanese market and manages group sales activities. It works with other global centers to produce innovative models for the world market.

## Big Wing



### Big Step (Japan)

Manufactures escalators and moving walks for the Japanese market and controls overseas manufacturing. It creates new products and modernization methods.

## Big Step



### Big Fit (Japan)

Provides high-quality after-sales service. It houses training facilities, a parts supply center, and the "Safe-Net Center" for remote product monitoring. Engineers from around the world visit here for education and training.

## Big Fit



### WING SQUARE

An extension of our R&D capabilities dedicated for shaping future possibility of VT transportation systems.



### WISDOM SQUARE

A dedicated facility for Quality Evaluation, ensuring the highest safety standards.



### Safenet Center

Safenet Center provides around-the-clock support to ensure the safety and reliability of your building's mobility. We integrate advanced remote digital monitoring with a rapid-response network for total peace of mind.

## SAFENET CENTER

# The World is a Single Market

Japan-quality products and solutions, delivered around the world. Based on Fujitec's business philosophy—"The market in the world is a single market"—Fujitec has expanded operations from Japan to many other countries. Today, our global business network covers the entire globe.

## EUROPE

FUJITEC UK LTD.

## MIDDLE EAST

FUJITEC EGYPT CO., LTD.  
FUJITEC SAUDI ARABIA CO., LTD.

## SOUTH ASIA

FUJITEC SINGAPORE CORPN. LTD.  
FUJITEC INC. (PHILIPPINES)  
FUJITEC (MALAYSIA) SDN. BHD.  
P.T. FUJITEC INDONESIA  
FUJITEC INDIA PRIVATE LTD.  
FUJITEC VIETNAM CO., LTD.  
FUJITEC (THAILAND) CO., LTD.  
FUJITEC LANKA PRIVATE LTD.  
FUJITEC MYANMAR CO., LTD.

## JAPAN

### Global Production Bases



#### Huasheng Fujitec Elevator Co., Ltd. (China)

- R&D Center(151m research tower) & Production Base.
- Products: ZEXIA, REXIA, ELISIA (Domestic & International).



#### Shanghai Huasheng Fujitec Escalator Co., Ltd. (China)

- Production Base.
- Products: Escalators and Moving Walkways (Domestic & International).



### Fujitec Sourcing Center

- Procures parts and equipment for global production bases.



### Fujitec Korea Co., Ltd.

- R&D Center (High-rise research tower) & Production Base.
- Products: ZEXIA, REXIA, ELISIA (Domestic & International).



### Fujitec Taiwan Co., Ltd.

- R&D Center & Production Base.
- Products: Elevators (Domestic) / Modernization Products (International).

## EAST ASIA

- HUASHENG FUJITEC ELEVATOR CO., LTD.
- SHANGHAI HUASHENG FUJITEC ESCALATOR CO., LTD.
- FUJITEC SHANGHAI SOURCING CENTER CO., LTD.
- FUJITEC SHANGHAI TECHNOLOGIES CO., LTD.
- FUJITEC (HK) CO., LTD.
- FUJITEC KOREA CO., LTD.
- FUJITEC TAIWAN CO., LTD.

## NORTH AMERICAS

- Fujitec America, Inc.
- Fujitec Canada, Inc.
- Elevadores EV Internacional, S.A. de C.V.
- FUJITEC PACIFIC, INC.

## SOUTH AMERICAS

- FUJITEC ARGENTINA S.A.
- FUJITEC URUGUAY S.A.

- Production Base
- Business Operation



### Fujitec India Private Ltd.

- R&D Center & Production Base.
- Products: ZEXIA and REXIA (Domestic & International).



### Fujitec America, Inc.

- R&D Center & Production Base.
- Products: Elevators for the North American market.



### Elevadores EV Internacional, S.A. de C.V.

- Production Base.
- Products: Elevators for the North American market.



## Commitment to Quality & Environment

ISO 9001: First achieved by Fujitec Japan in 1993; now held by group companies in 10 countries across Asia, Europe, the Middle East, and the Americas.

ISO 14001: Fujitec Japan achieved this in 1999, followed by the certification of our group companies in Hong Kong, Singapore, the United Kingdom, Korea, Taiwan, China, and India.

Global Quality Assurance: Our global manufacturing network (Japan, Taiwan, Korea, China, India, USA, and Mexico) ensures consistent, world-class performance and safety.



## Solar Power Initiative

Clean Energy Generation: Utilizing an on-site Power Purchase Agreement (PPA) to generate renewable energy directly at our facility.

Large-Scale Installation: Operating approximately 1,000 solar panels to sustainably power our on-site factory operations.

Group-Wide Expansion: Installing solar panels across the offices and plants of our various group companies.

Environmental Impact: Significantly reducing our reliance on the traditional power grid and lowering our overall operational carbon footprint.



## CDP Climate Change Score: B

### Moving Beyond Disclosure to Action

Fujitec Co., Ltd. has consistently earned a "B" score (Management Level) in the climate change category from CDP, the global environmental disclosure system.

Maintaining this rating since 2023 serves as proof of our proactive commitment to environmental management. It recognizes that Fujitec has moved beyond mere disclosure to actively address and mitigate climate-related risks and impacts. Since reducing our environmental footprint is one of our core sustainability materialities, the entire Fujitec Group remains united in driving environmental initiatives forward, continuously focusing on reducing greenhouse gas (GHG) emissions worldwide.



## Environmental Product Declarations (EPDs)

**Transparency:** EPDs completed in 2022 for the ZEXIA, REXIA, and ELISIA models.

**Standards:** Compliant with ISO 14025, our EPDs utilize "cradle-to-grave" Life Cycle Assessments (LCA).

**Green Building Support:** Our data helps clients achieve certifications like BREEAM by providing a clear picture of environmental impact.



Our first EPDs were completed in 2022 for the ZEXIA, REXIA, and ELSIA models.

An EPD is a Type III environmental labeling certification compliant with ISO 14025. They are founded on Life Cycle Assessment (LCA) based on a "cradle-to-grave" system boundary.

By providing data on environmental impact throughout a product's life cycle, EPDs enable consumers to select environmentally conscious products. Recognized by green building schemes such as BREEAM, our EPDs contribute to our clients' building certifications.

## Environmental Strategy

To combat global warming and support a decarbonized society, Fujitec is dedicated to:

- Reducing GHG emissions in accordance with ISO 14001.
- Implementing TCFD-compliant environmental strategies
- Optimizing operations to enhance eco-efficiency.

Latest Updates:  
[fujitec.com/sustainability/environment](https://www.fujitec.com/sustainability/environment)



<https://www.fujitec.com/sustainability/environment>

## Initiatives & External Evaluations



Global Compact  
Network Japan



TASK FORCE ON  
CLIMATE-RELATED  
FINANCIAL  
DISCLOSURES



Digital Transformation  
Certification



2025  
健康経営優良法人  
KENKO Investment for Health  
大規模法人部門

## United Nations Global Compact (UNGC)

We uphold the UNGC's ten principles in human rights, labor, environment, and anti-corruption. This aligns with our core philosophy:

"Respecting people, technologies, and products, we collaborate with nations around the world to develop beautiful and functional cities that meet the needs of a new age."

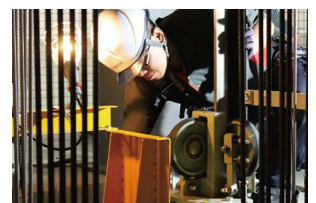

Moving freely. Elevating lives



[www.fujitec.com](http://www.fujitec.com)



Global Network